

209C

Two-Post Lift

9,000-lb. Capacity, Clearfloor, Adjustable Height

babco

Questions? Contact Babco's Sales Team
info@babco.ca | 1-800-661-5313

Adjustable Height & 3-Stage Arms

The 209C 9,000-lb. capacity 2-post lift features a direct-drive hydraulic system, adjustable height, clear-floor design and 4 three-stage arms, making this the perfect lift to accommodate a wide range of vehicles.

Features

- 9,000-lb. lifting capacity
- 4 Three-stage arms allow servicing a wider variety of vehicles
- Dual hydraulic cylinders with high quality oil seals
- 3/8" aircraft quality cables
- Self-lubricating UHMW polyethylene sliders and bronze bushings
- Single-point safety release
- Adjustable Height
- Clearfloor design provides unobstructed floor space
- Automatic arm restraints
- Stackable adapters 1.5", 2.5" & 5"
- Optional height & width extensions available



Front and Rear
3-Stage Telescoping Arms

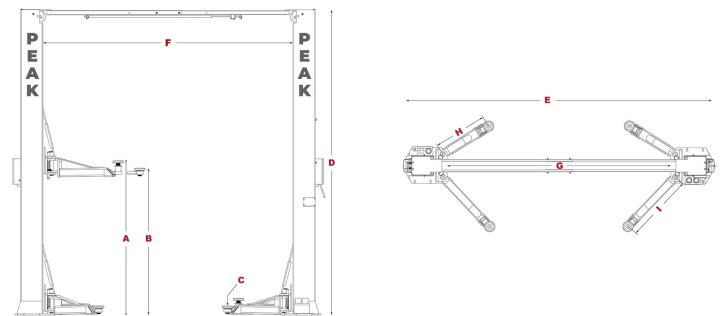

Model	209C
Style:	Clearfloor Direct-Driven
Lifting Capacity (lbs):	9,000
Lifting Time:	57 seconds
(A) Rise + Pad + Stackable Adaptors on Top Lock:	78.9" (2,004 mm)
(B) Rise + Pad on Top Lock:	69.9" (1,775 mm)
(C) Min. Height + Pad:	3.5" (90 mm)
(D) Height Overall:	142.5" (3,621 mm) - 150.5" (3,821 mm)
(E) Width Overall:	135" (3,428 mm)
(F) Inside COLUMNS:	112.3" (2,852 mm)
(G) Drive-Thru Clearance:	99.5" (2,528 mm)

Warranty: Peak Lifts are warranted for (5) years on structural components, (2) years on hydraulic parts and (1) year on power units and electrical components to the original owner.

5488 192 Street, Surrey, BC V3W 8E5 • 1065 Stacey Court, Mississauga, ON L4W 2X7 • Toll-free 1-800-661-5313